

**KARTA KATALOGOWA KOTŁA MOD. CSA650 GM**  
**TECHNICAL FEATURES AND DIMENSION BOILER MOD. CSA650GM**

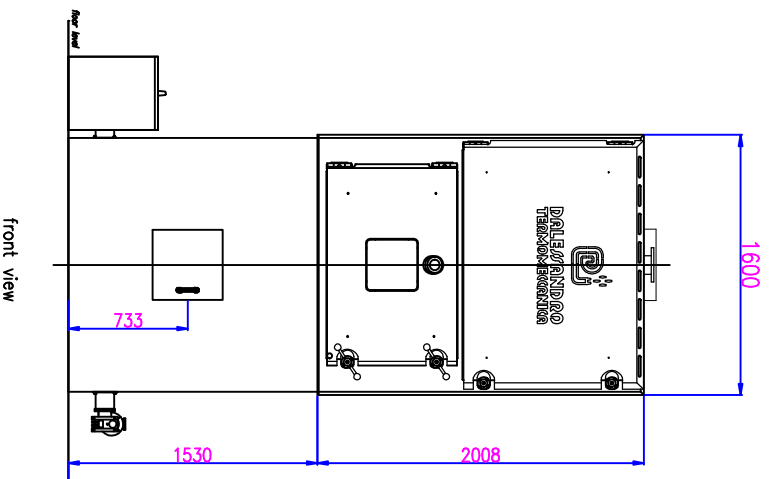
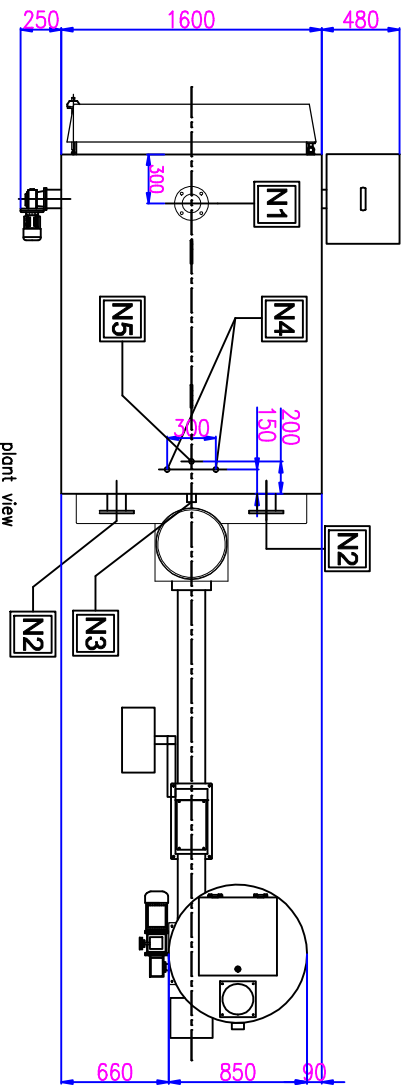
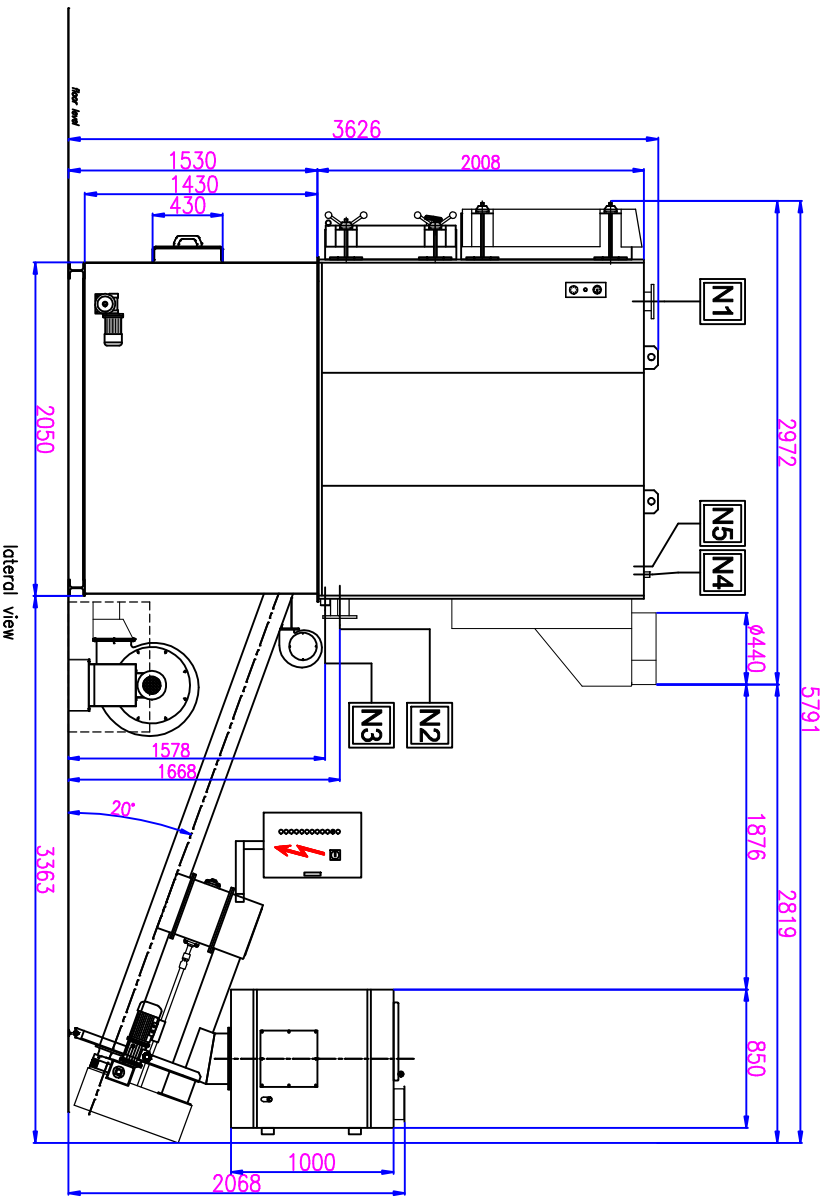

documento n°/document n°	<b>DS-091</b>	emissione // issued	<b>25/10/2012</b>
modello n°/model n°	<b>0</b>		

**DATI TECNICI**

PRINCIPALI CARATTERISTICHE			
potenza nominale	nominal output	(kW)	650
potenza polifase	polyphase power	(kW)	765
pressione operativa	max operating pressure	(bar)	3
pressione differenziale	differential pressure	(bar)	4,5
temperatura massima operativa	max operating temperature	(°C)	90
potenza elettrica	net electric power	(kW/h)	400
descrizione usura elettrica	electrical wear description	(kW/h)	n.d.
consumo polifase	polyphase consumption	(kg/h)	n.d.
potenza polifase	polyphase power	(kW)	1580
potenza differenziale	differential power	(kW)	1920
potenza elettrica	net electric power	(kW)	580
potenza elettrica	net electric power	(kW)	2600
potenza elettrica	net electric power	(kW)	2800
potenza elettrica	net electric power	(kW)	5400
potenza elettrica	net electric power	(kW)	440
potenza elettrica	net electric power	(kW)	1157

Usare combustibili: wood shavings, wood in pieces, sawdust, pellets, chips, wood chips, wood chips with moisture above the 30%

**PRZYŁĄCZA HYDRAULICZNE**

PRZYŁĄCZA HYDRAULICZNE			
N1	zasilanie	(DN)	100
N2	power	(DN)	100
N3	spust wody	(DN)	40
N4	czujnik powrotu	(DN)	25
N5	czujnik temperatury	(DN)	15